

ROHS
Compatible

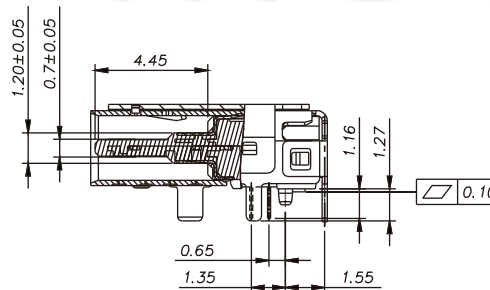
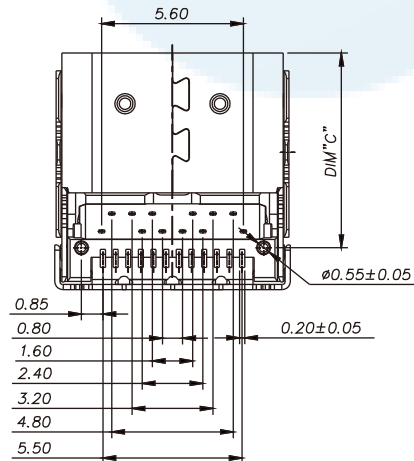
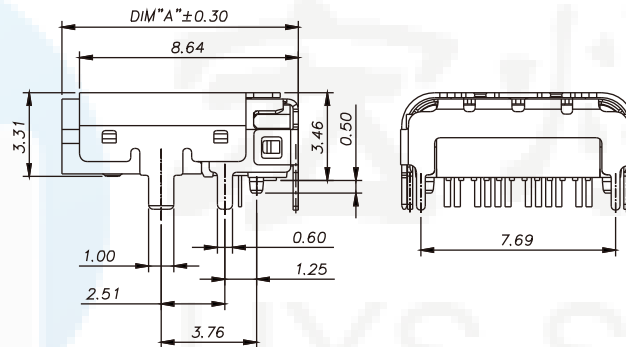
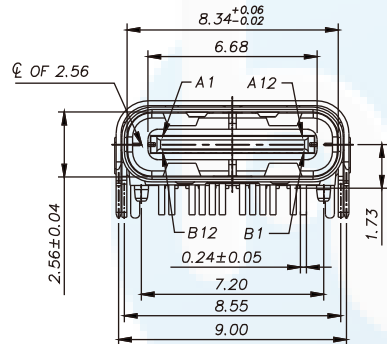
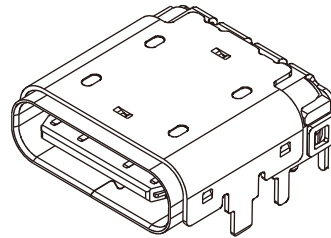
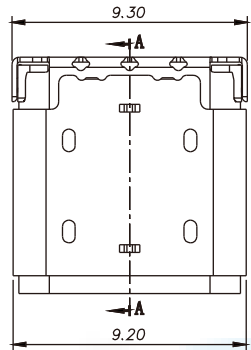

NOTE:

1.MATERIAL SPECIFICATION:

- 1.HOUSING:LCP COLOR SEE TABLE 1,UL94 V-0.
- 2.CONTACTS:COPPER ALLOY(C1814)
- 3.MID PLATE&SPRING: STAINLESS STEEL (SUS301)
- 4.FRONT SHELL&COVER: STAINLESS STEEL (SUS304)

2.PLATING SPECIFICATION:

2- 1.CONTACTS:

- Ni 50u" MIN. UNDER PLATED OVER ALL.
- Au PLATED ON THE FUNCTIONAL AREA OF CONTACT.
- (GOLD PLATING THICKNESS FOLLOW THE P/N)
- PLATING SPECIFICATIONS OF THE SOLDER AREA FOLLOW THE P/N

2-2.FRONT SHELL & COVER:

- Ni 30u" MIN. UNDER PLATED OVER ALL.

2-3.MID PLATE & EMI SPRING:

- CLEAR ONLY

3.MECHANICAL PERFORMANCE,

- 3- 1.INSERTION FORCE: 0.5~2.0kgf.
- 3-2.REMOVAL FORCE: 0.8kgf~2.0kgf.
- 3-3.DURABILITY: 10000 CYCLES.

4.ELECTRICAL PERFORMANCE,

- 4- 1. CURRENT RATING: 3.0A
VOLTAGE RATING: 5.0V
- 4-2. LLCR:
VBUS & GND PINS AND OTHER PINS: 40mΩ/PIN MAX.
SHIELD: 50mΩ/MAX.
LLCR MAX. CHANGE OF ALL PINS: 10mΩ
- 4-3.INSULATION RESISTANCE: 100MΩ MIN
- 4-4.DIELECTRIC WITHSTAND VOLTAGE,AC 100V FOR 1 MINUTE.

5. ENVIRONMENTAL PERFORMANCE:

- OPERATING TEMPERATURE: -25°C~+85°C.

6.IR REFLOW:

- THE PEAK TEMPERATURE ON THE BOARD SHALL BE MAINTAINED FOR 10 SECONDS AT 260°C.

DESIGN	Li Jinwei	SCALL	
DRAWING	Wu Qifa	UNIT	mm
CHECK	Zheng Jinxian	SIZE	A4: 210 * 297
APPROVAL	Liu Xiaohong	DATE	2020-06-10

TOLERANCE	
X.X ±0.30	X.°±2°
.XX ±0.20	.X° ±1°
.XXX ±0.10	.XX°±0.5°

DRAWG NO.	TYPE-C-DSJ24PZ934
TITLE:	24P 双壳六脚插板DIP+SMT 9.34L

东莞市宏煜盛实业有限公司

Dongguan hongyusheng Industry Co., Ltd

TEL: 0769-81230179 <https://www.hystypec.com>

ROHS
Compatible

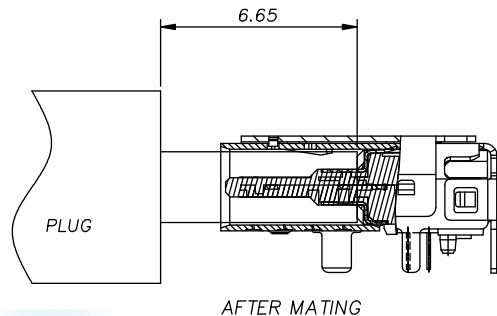

USB TYPE-C PIN ASSIGNMENTS

PIN NUMBER	SIGNAL NAME	PIN NUMBER	SIGNAL NAME
A 1	GND	B 12	GND
A 2	SSTXp1	B 11	SSRXp1
A 3	SSTXn1	B 10	SSRXn1
A 4	VBus	B 9	VBus
A 5	CC1	B 8	SBU2
A 6	Dp1	B 7	Dn2
A 7	Dn1	B 6	Dp2
A 8	SBU1	B 5	CC2
A 9	VBus	B 4	VBus
A 10	SSRXn2	B 3	SSTXn2
A 11	SSRXp2	B 2	SSTXp2
A 12	GND	B 1	GND

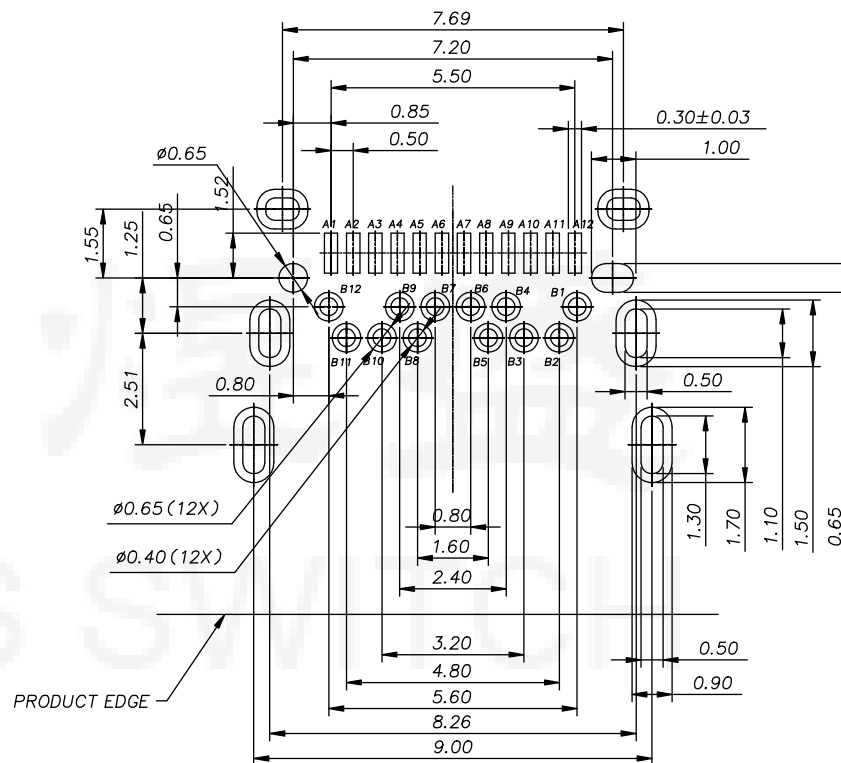

SCALE 1.5: 1

RECOMMENDED PCB LAYOUT (TOP VIEW)
THICKNESS 1.0 MM; DEFAULT TOLERANCE: ±0.05

TABLE 1

ITEM	P/N	DIM"A"	DIM"C"	HOUSING COLUR	PLATING	
					MATING AREA	SOLDER AREA
1	TYPE-C-DSJ24PZ934-01	9.34	7.69	BALCK	Au: 3u"	Au: G/F
2	TYPE-C-DSJ24PZ934-02	9.34	7.69		Au: 30u"	

DESIGN	Li Jinwei	SCALL		 TOLERANCE X.X ±0.30 X.°±2° .XX ±0.20 .X°±1° .XXX ±0.10 .XX°±0.5°	DRAWG NO.	TYPE-C-DSJ24PZ934
DRAWING	Wu Qifa	UNIT	mm		TITLE:	24P 双壳六脚插板DIP+SMT 9.34L
CHECK	Zheng Jinxian	SIZE	A4: 210 * 297			
APPROVAL	Liu Xiaohong	DATE	2020-06-10			



东莞市宏煜盛实业有限公司
Dongguan hongyusheng Industry Co., Ltd
TEL: 0769-81230179 <https://www.hystypec.com>

ROHS
Compatible

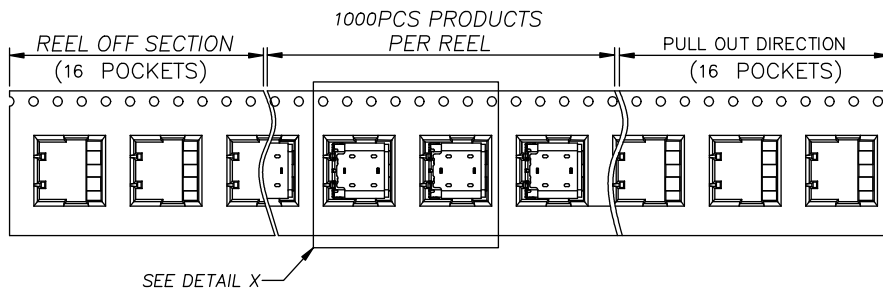
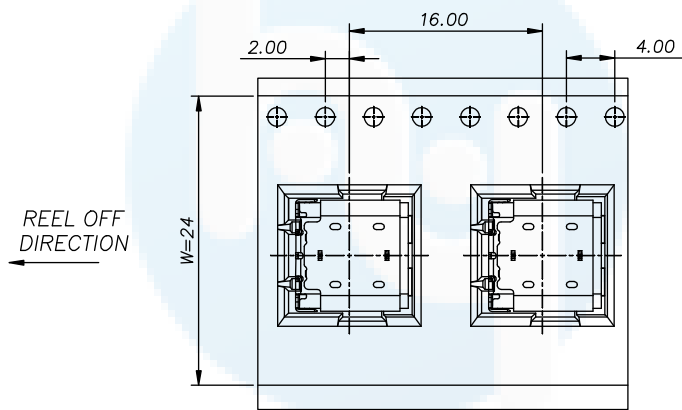
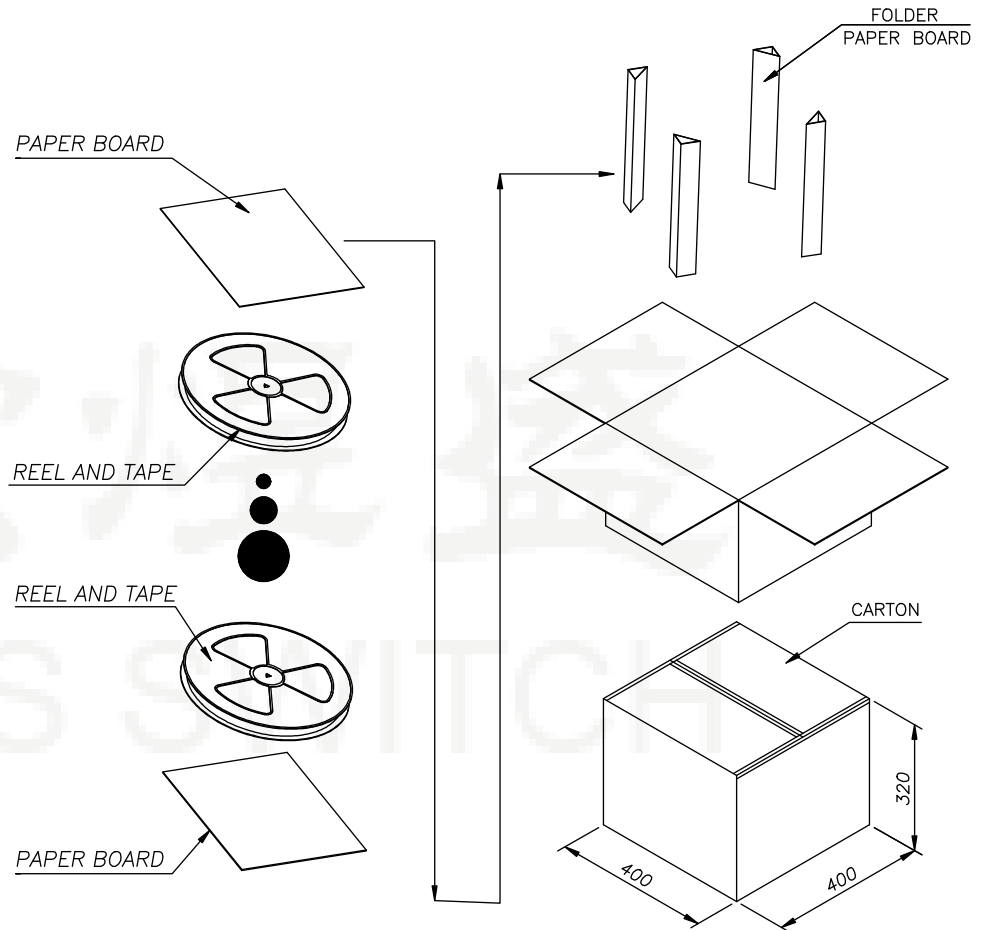
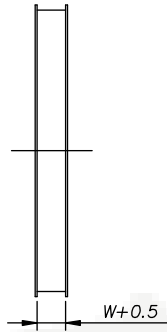
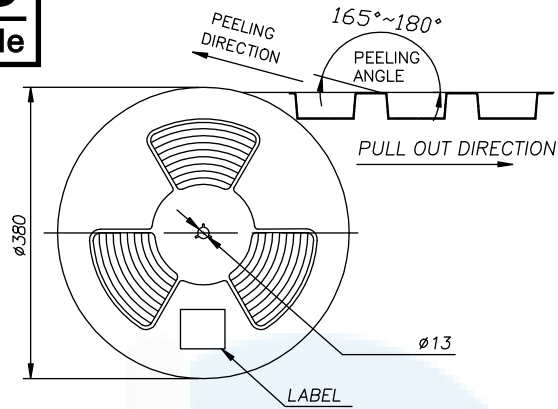

	REEL/TRAY	CARTON
CONNECTOR (PCS)	1000	10000

DESIGN	Li Jinwei	SCALL		
DRAWING	Wu Qifa	UNIT	mm	
CHECK	Zheng Jinxian	SIZE	A4: 210 * 297	
APPROVAL	Liu Xiaohong	DATE	2020-06-10	

DRAWG NO.	TYPE-C-DSJ24PZ934
TITLE:	24P 双壳六脚插板DIP+SMT 9.34L



东莞市宏煜盛实业有限公司
Dongguan hongyusheng Industry Co., Ltd
TEL: 0769-81230179 <https://www.hystypec.com>