

**ROHS**  
Compatible

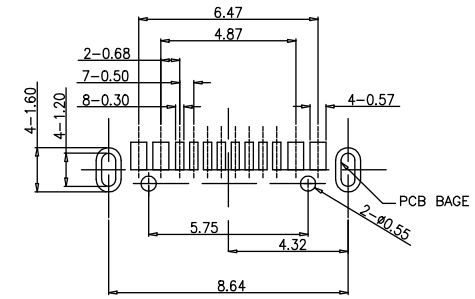

PCB LAYOUT  
GENERAL TOLERANCES: ±0.05

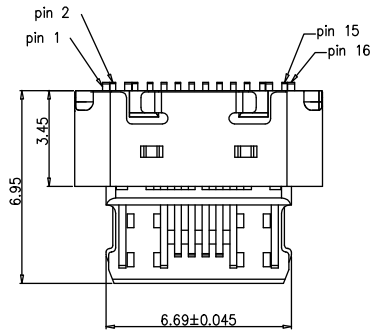
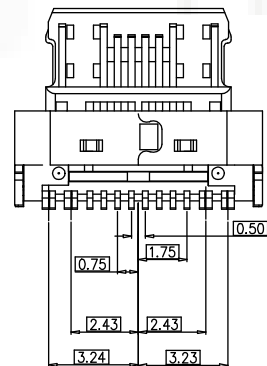
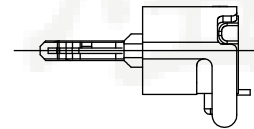
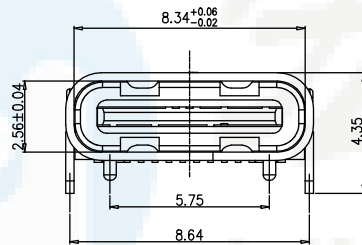
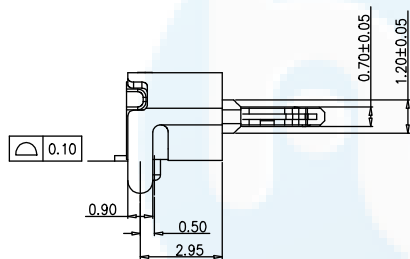

**备注:**

**1. 材質:**

- 1.1 端子: C5191R-EH, T=0.15mm.
- 1.2 胶芯: LCP+30%GF; 顏色: 黑色
- 1.3 外壳: SUS 304R-1/2H. T0.30mm

**2. 电镀:**

- 2.1 端子: 电镀镍底50u"Min. (焊接区域) 锡脚电镀亮锡80u"Min.
- 2.2 外壳: 电镀镍底50u"Min.

DESIGN	Li Jinwei	SCALL	
DRAWING	Wu Qifa	UNIT	mm
CHECK	Zheng Jinxian	SIZE	A4: 210 * 297
APPROVAL	Liu Xiaohong	DATE	2020-06-10

DRAWG NO.	TYPE-C-DSW16PZ345
TITLE:	16P两脚插板SMT舌片外露3.45L

 **东莞市宏煜盛实业有限公司**  
Dongguan hongyusheng Industry Co., Ltd  
TEL: 0769-81230179 <https://www.hystypec.com>