

ROHS
Compatible

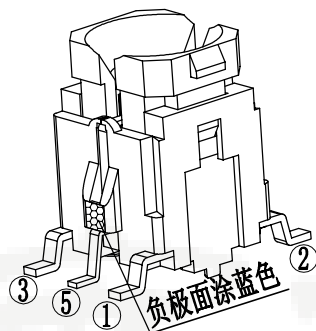

元件面孔位图

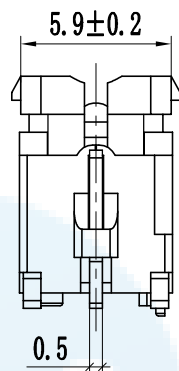
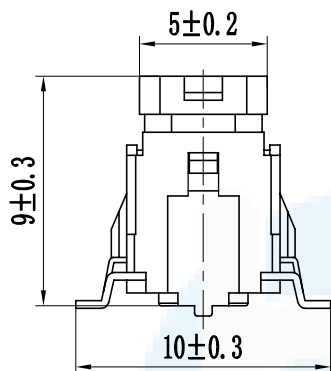
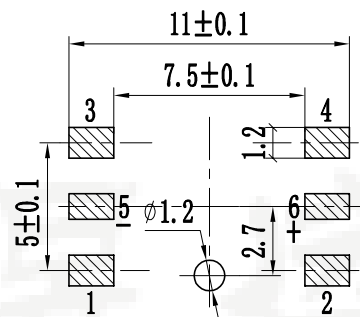

电原理图

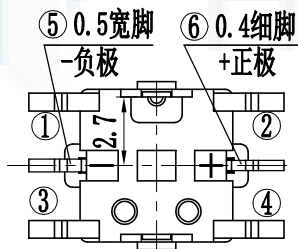
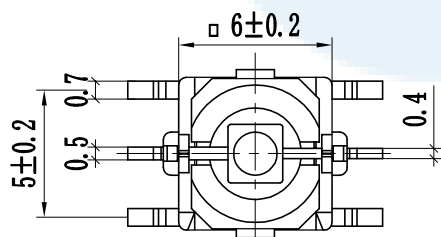
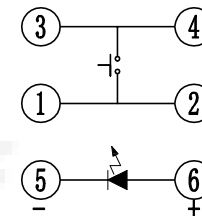

轻触开关主要技术指标: Main Specifications:

气候等级 Climate Grade	额定值 Rated Values	接触电阻 Contact Resistance	耐电压 Dielectric Strength	绝缘电阻 Insulation Resistance	动作力 Operating Force	寿命 Life	盐雾试验 Salt mist. Test
-25℃ 至 +75℃	30V DC, 30mA	≤0.05 Ω	250V AC	≥100M Ω	260gf±50gf	10W times	12±1 hours.

序号	零件料号	名称	材料	数量	镀层/颜色	备注
5	——	LED灯		1	透明	A0630蓝灯
4	——	圆按钮	PPA	1	瓷白	借A0666
3	——	弹片	不锈钢	1	Ag	A0630(φ4.5)
2	——	塑座	PPA	1	黑色	A0630(6x9H)
1	——	卡件	H62	1	Ag	A0630

DESIGN	Li Jinwei	SCALL		 TOLERANCE X.X ±0.30 X.°±2° .XX ±0.20 .X°±1° .XXX ±0.10 .XX°±0.5°
DRAWING	Wu Qifa	UNIT	mm	
CHECK	Zheng Jinxian	SIZE	A4: 210 * 297	
APPROVAL	Liu Xiaohong	DATE	2020-06-10	

DRAWG NO.	LTS-6141S
TITLE:	6X6X9H 260gf10W贴10长 蓝灯



东莞市宏煜盛实业有限公司
Dongguan hongyusheng Industry Co., Ltd
TEL: 0769-81230179 <https://www.hystypec.com>